

REV.	DESCRIPTION	ECN NO.	NAME	DATE
0-1	structure changed	N/A	CLOUD	2015-03-14
2	size changed	N/A	WANG	2018-05-17
3	UPDATE DRAWING	N/A	ZLX	2018-11-26
4	UPDATE THE DRAWING FRAME	N/A	PY	2020-06-20
5	AMEND INSULATOR	N/A	Liu	2021-03-19

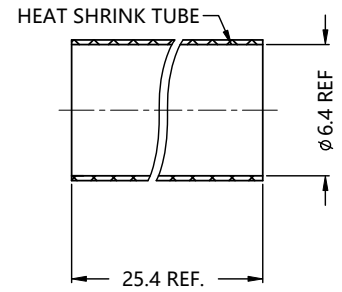

ALL PARTS MUST MEET TO RoHS REQUIREMENTS

REMARK:  
 1. CRIMPED FERRULE HEX. CRIMP SIZE .186"  
 2. CONTACT PIN TO SOLDER

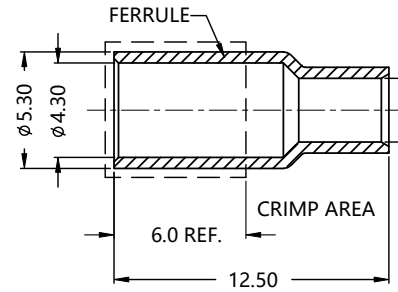
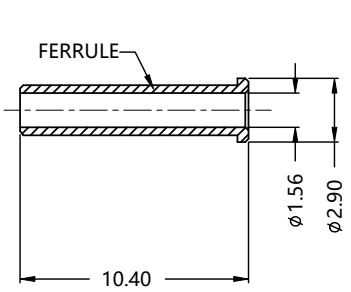
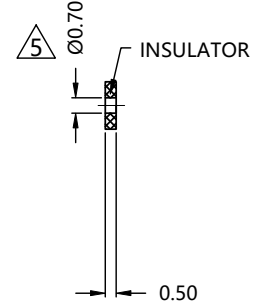
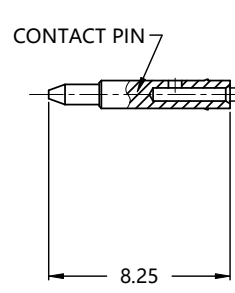
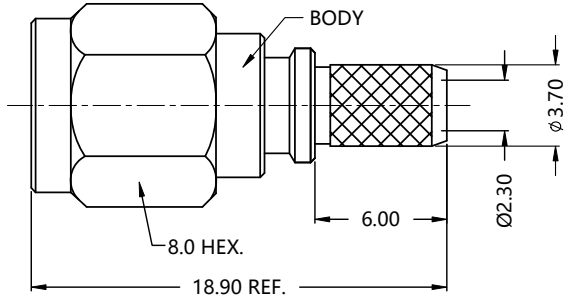
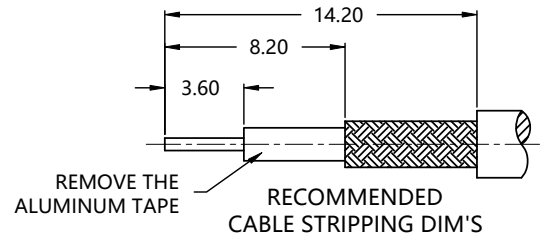

MATERIALS AND PLATING		UNIT: MICRO-INCHES
PART NAME	MATERIALS	PLATING
BODY/SHELL	BRASS C3604	NICKEL 200 u"/COPPER
INSULATOR	PTFE ASTM-D-1710	N/A
CONTACT PIN	BRASS C3604	GOLD 15 u"/NICKEL/COPPER
GASKET	SILICONE	RED
FERRULE	BRASS C3604	NICKEL 200 u"/COPPER

ELECTRICAL CHARACTERISTICS	
IMPEDANCE	50 Ω
VOLTAGE RATING	335 V(rms)
FREQUENCY RANGE	0 ~ 6 GHz
DIELECTRIC WITHSTANDING VOLTAGE	> 500 V
CONTACT RESISTANCE	CENTER CONTACT < 3.0 mΩ
	OUTER CONTACT < 2.0mΩ
INSULATION RESISTANCE	> 5000 MΩ
INSERTION LOSS	N/A
VSWR	< 1.20@0-3GHz < 1.30@3-6GHz
3RD INTERMODULATION	N/A

MECHANICAL CHARACTERISTICS	
FORCE TO ENGAGE AND DISENGAGE	N/A
CENTER CONTACT RETENTION FORCE	N/A
RECOMMENDED COUPLING TORQUE	7~10 in.lbs
COUPLING NUT RETENTION FORCE	>60 lbs
DURABILITY	>500cycles

ENVIRONMENTAL PARAMETER	
TEMPERATURE RANGE	-40 °C~+125 °C
THERMAL SHOCK	MIL- STD 202, Meth. 107,Cond. B
Vibration	MIL-STD-202,Method 204,Cond D
Shock	MIL-STD-202,Method 213,Cond I

\* CUSTOMER OUTLINE DRAWING

UNLESS OTHERWISE SPECIFIED:  
 1) EDGES : C0.15 MAX ;  
 2) REMOVE ALL BURRS ;  
 3) SURFACE ROUGHNESS : Ra1.6 ;  
 4) UNITS : mm ;  
 5) DIMENSIONS TOLERANCES  
 DECIMALS : .x ±0.3 .xx ±0.2 .xxx±0.1;  
 ANGLES : ± 5°.

THIRD ANGLE PROJECTION

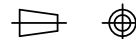

APPROVED :

CUSTOMER P/N :

CHECKED :

SCALE :

1 : 1

DRAWING :

DATE : 2021-03-19

PAGE : 1/1



TITLE : SMA MALE S/T FOR LMR-100A/UF CABLE,50Ω

DRAWING NO. : 5MAM11S-A02

COMPANY WEBSITE : www.slkcorp.com

CUSTOMER OUTLINE DRAWING