

REV.	DESCRIPTION	ECN NO.	NAME	DATE
2	UPDATE APPEARANCE	ECN1909025	LTZ	2019-09-27
3	NEW FRAME	N/A	Liu	2020-09-27

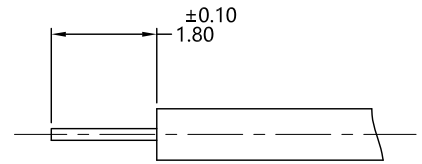

ALL PARTS MUST MEET TO RoHS REQUIREMENTS

REMARKS:
1. CONTACT PIN TO CAPTIVE
2. BODY TO SOLDER



RECOMMENDED CABLE STRIPPING DIM'S

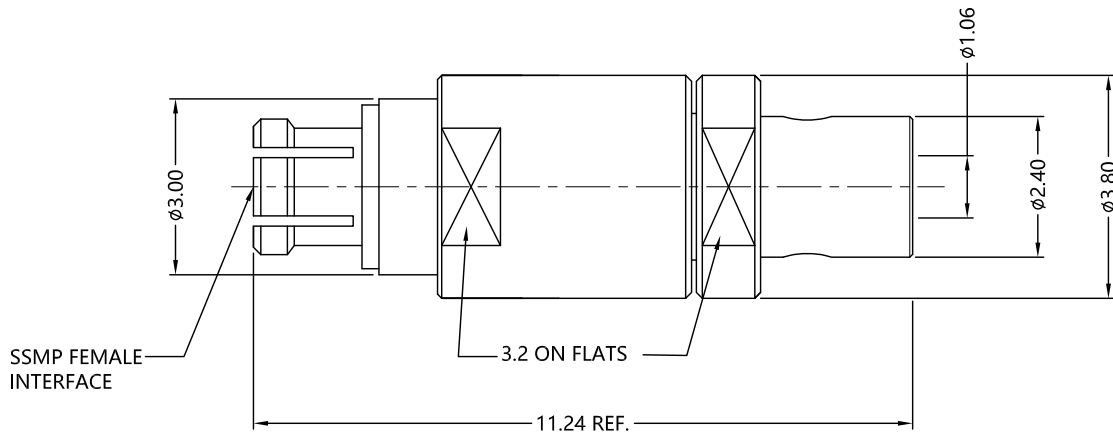

MATERIALS AND PLATING		UNIT: MICRO-INCHES
PART NAME	MATERIALS	PLATING
BODY	BRASS	GOLD 10 u"/NICKEL/COPPER
BODY	Be-Cu C17300	GOLD 30 u"/NICKEL/COPPER
INSULATOR	PEEK	N/A
CONTACT PIN	Be-Cu C17300	GOLD 50 u"/NICKEL/COPPER

ELECTRICAL CHARACTERISTICS	
IMPEDANCE	50 Ω
VOLTAGE RATING	175 V(rms)
FREQUENCY RANGE	0 ~ 40 GHz
DIELECTRIC WITHSTANDING VOLTAGE	>500 V
CONTACT RESISTANCE	CENTER CONTACT
	OUTER CONTACT
INSULATION RESISTANCE	>1000 MΩ
INSERTION LOSS	$<0.1 \times \sqrt{F(\text{GHz})}$ dB
VSWR	<1.5
3RD INTERMODULATION	N/A

MECHANICAL CHARACTERISTICS		
CENTER CONTACT RETENTION FORCE		>3 lbs
Engagement force	Full detent	<4.5 lbs
	Smooth bore	<2.5 lbs
Disengagement force	Full detent	<6.5 lbs
	Smooth bore	<1.5 lbs
DURABILITY	Full detent	>100 cycles
	Smooth bore	>500 cycles

ENVIRONMENTAL PARAMETER	
TEMPERATURE RANGE	-40 °C ~ +125 °C

* CUSTOMER OUTLINE DRAWING

UNLESS OTHERWISE SPECIFIED:
1) EDGES : C0.15 MAX ;
2) REMOVE ALL BURRS ;
3) SURFACE ROUGHNESS : Ra1.6 ;
4) UNITS : mm ;
5) DIMENSIONS TOLERANCES
DECIMALS : .x ±0.3 .xx ±0.2 .xxx±0.1;
ANGLES : ± 5°.

THIRD ANGLE PROJECTION	
APPROVED :	CUSTOMER P/N :
CHECKED :	SCALE :
DRAWING :	DATE :
PAGE : 1/1	

TITLE : SSMP FEMALE S/T SOLDER FOR .034 inch Semi-rigid CABLE,50Ω
DRAWING NO. : 5MPF15S-A627
COMPANY WEBSITE : www.slkcorp.com

CUSTOMER OUTLINE DRAWING