

REV.	DESCRIPTION	ECN NO.	NAME	DATE
A1	NEW FRAME	N/A	LDH	2020-6-19

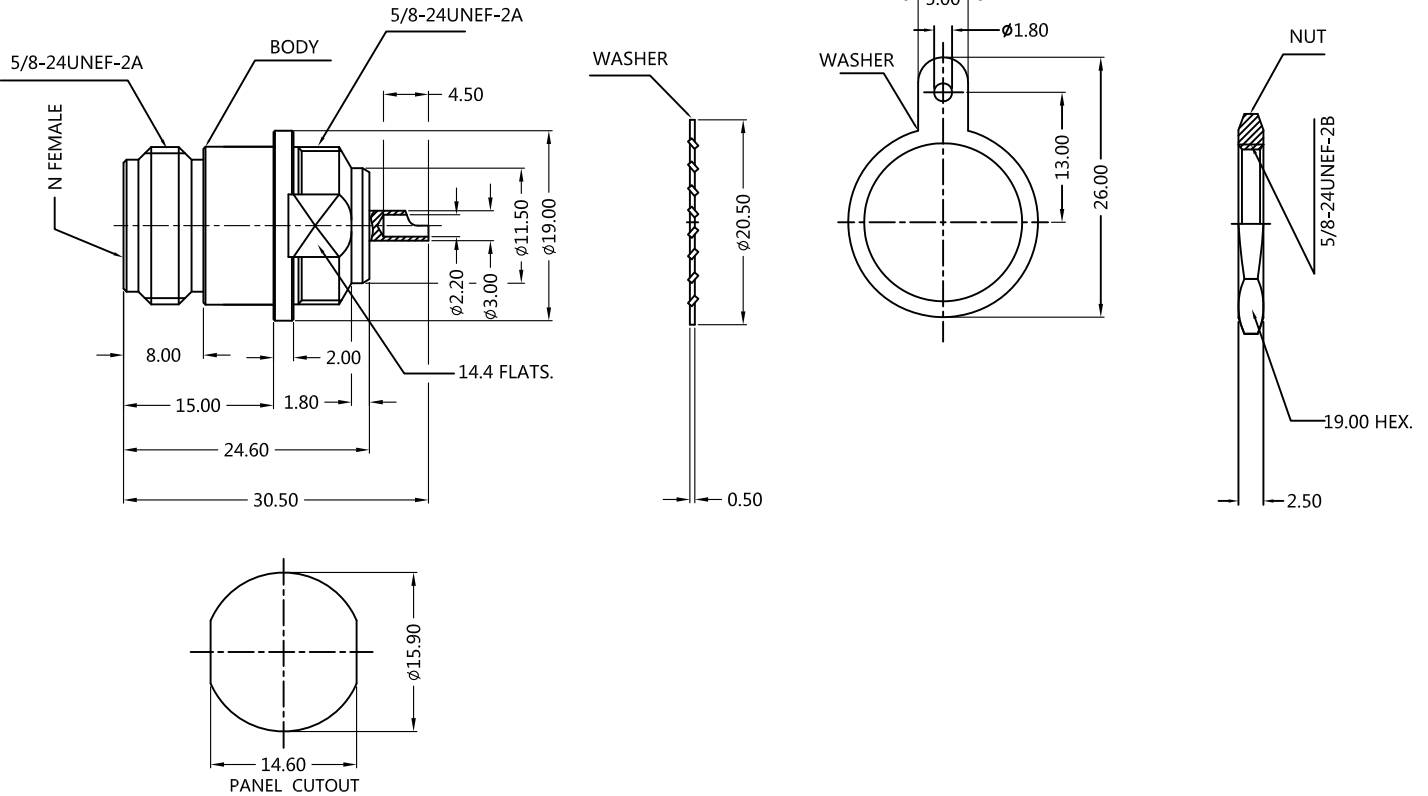

ALL PARTS MUST MEET TO RoHS REQUIREMENTS

REMARK:
1 CONTACT PIN TO SOLDER



MATERIALS AND PLATING		UNIT: MICRO-INCHES
PART NAME	MATERIALS	PLATING
BODY	BRASS C3602	SILVER 40 u"MIN/COPPER
INSULATOR	PTFE MIL-P-19468	N/A
CENTER PIN/NUT	BRASS C3604	SILVER 40 u"MIN/COPPER
WASHER	BRASS C2600	SILVER 40 u"MIN/COPPER
WASHER	BRASS C3602/H62	SILVER 40 u"MIN/COPPER

ELECTRICAL CHARACTERISTICS		
IMPEDANCE	50 Ω	
VOLTAGE RATING	1000 V(rms)	
FREQUENCY RANGE	DC~11 GHz	
DIELECTRIC WITHSTANDING VOLTAGE	>2500 V	
CONTACT RESISTANCE	CENTER CONTACT	<1.0 mΩ
	OUTER CONTACT	<1.0 mΩ
INSULATION RESISTANCE	>5000 MΩ	
INSERTION LOSS	N/A	
VSWR	<1.40	
3RD INTERMODULATION	N/A	

MECHANICAL CHARACTERISTICS	
FORCE TO ENGAGE AND DISENGAGE	N/A
CENTER CONTACT RETENTION FORCE	6 lbs
RECOMMENDED COUPLING TORQUE	N/A
COUPLING NUT RETENTION FORCE	>60 lbs
DURABILITY	>500cycles

ENVIRONMENTAL PARAMETER	
TEMPERATURE RANGE	-65 °C~+165 °C
THERMAL SHOCK	US MIL- STD 202, Meth. 107,Cond. B
VIBRATION	US MIL- STD 202, Meth. 204,Cond. B
SHOCK	US MIL- STD 202, Meth. 213,Cond. I

* CUSTOMER OUTLINE DRAWING

UNLESS OTHERWISE SPECIFIED:

- 1) EDGES : C0.15 MAX ;
- 2) REMOVE ALL BURRS ;
- 3) SURFACE ROUGHNESS : Ra1.6 ;
- 4) UNITS : mm ;
- 5) DIMENSIONS TOLERANCES
DECIMALS : .x ±0.3 .xx ±0.2 .xxx±0.1;
ANGLES : ± 5°.

THIRD ANGLE PROJECTION

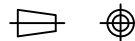

APPROVED :

CUSTOMER P/N :

CHECKED :

SCALE :

3 : 2

DRAWING :

LDH

DATE : 2020-6-19

PAGE : 1/1



TITLE : N FEMALE S/T BULKHEAD SOCKET FRONT MOUNT 50-OHM

DRAWING NO. : 5NCF11S-A00-001

COMPANY WEBSITE : www.slkcorp.com

CUSTOMER OUTLINE DRAWING