

1	2	3	4	5	6
REV	DESCRIPTION	ECN NO	NAME	DATE	
0	FIRST EDITION	N/A	Liu	2022-09-20	

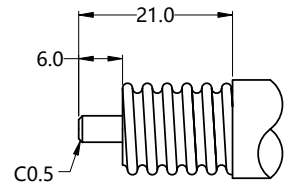

ALL PARTS MUST MEET TO RoHS REQUIREMENTS

REMARKS:
 1.ADDS SIZE:10.5mm
 2.CONTACT PIN AND BODY TO SOLDER



RECOMMENDED CABLE STRIPPING DIM'S

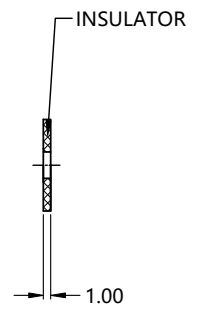
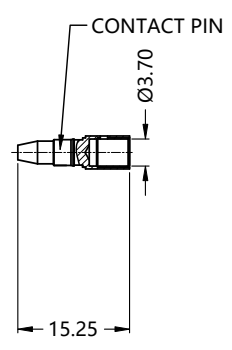
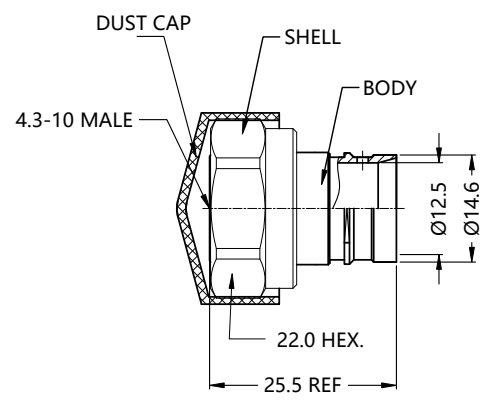

MATERIALS AND PLATING		UNIT: MICRO-INCHES
BODY/SHELL	BRASS C3604	ALBALOY 100 u" /COPPER
CONTACT PIN	BRASS	SILVER 200 u" /COPPER
INSULATOR	PTFE ASTM-D-1710	N/A

ELECTRICAL CHARACTERISTICS	
IMPEDANCE	50 Ω
VOLTAGE RATING	835 V(rms)
FREQUENCY RANGE	DC~6 GHz
DIELECTRIC WITHSTANDING VOLTAGE	>2500 V
CONTACT RESISTANCE	CENTER CONTACT <1.0 mΩ
	OUTER CONTACT <1.0 mΩ
INSULATION RESISTANCE	>5000 MΩ
INSERTION LOSS	<0.05√F dB
VSWR	<1.30
3RD INTERMODULATION	>160 dBc @ 2x43 dBm (@ 700 MHz & 1800 MHz)

MECHANICAL CHARACTERISTICS	
FORCE TO ENGAGE AND DISENGAGE	N/A
CENTER CONTACT RETENTION FORCE	N/A
RECOMMENDED COUPLING TORQUE	5 Nm
COUPLING NUT RETENTION FORCE	> 100 lbs
DURABILITY	>500 cycles

ENVIRONMENTAL CHARACTERISTICS	
TEMPERATURE RANGE	-40 °C~+125 °C

* CUSTOMER OUTLINE DRAWING

UNLESS OTHERWISE SPECIFIED:
 1) C0.15 MAX;
 2) REMOVE ALL BURRS;
 3) SURFACE ROUGHNESS : Ra1.6;
 4) UNITS:mm;
 5) DIMENSIONS TOLERANCES
 DECIMALS .x ±0.3 .xx ±0.2 .xxx±0.1
 ANGLES ±5°

THIRD ANGLE PROJECTION	
APPROVED:	CUSTOMER P/N:
CHECKED:	SCALE:
DRAWING:	DATE: 2022-09-20
COMPANY WEBSITE: www.slkcorp.com	



TITLE: 4.3-10 MALE S/T SOLDER FOR 1/2" SUPER FLEXIBLE CABLE,50Ω
 DRAWING NO: 5SDM15S-LS12-006