

REV.	DESCRIPTION	ECN NO.	NAME	DATE
3	NEW FRAME	N/A	GUO	2020-07-20

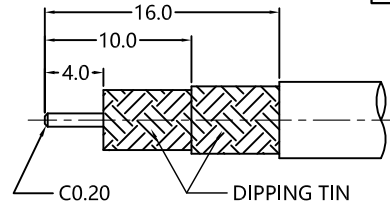

ALL PARTS MUST MEET TO RoHS REQUIREMENTS

REMARKS:
1. ADDS SIZE: 11.95 mm
2. CONTACT PIN TO SOLDER



RECOMMENDED CABLE STRIPPING DIM'S

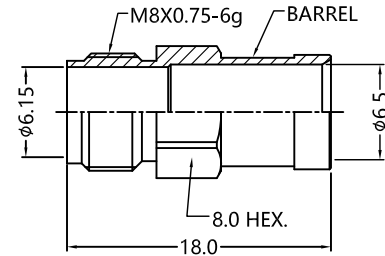
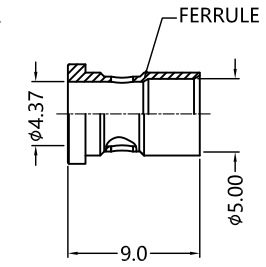
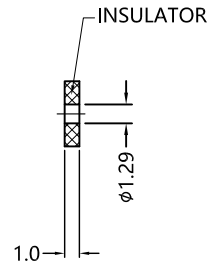
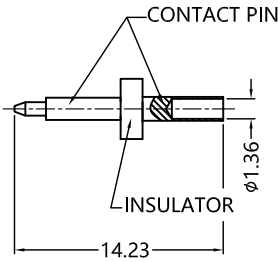
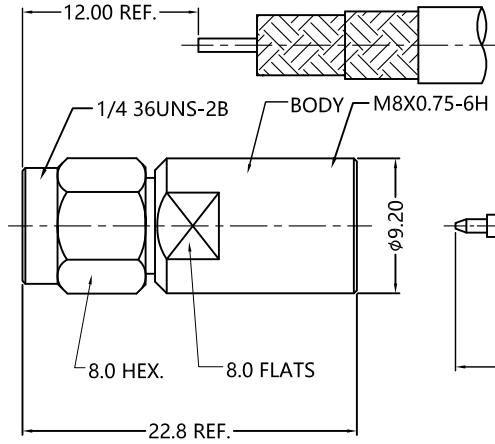

MATERIALS AND PLATING		UNIT: MICRO-INCHES
PART NAME	MATERIALS	PLATING
BODY/SHELL	STAINLESS STEEL	PASSIVATION
INSULATOR	PEEK&PTFE	N/A
CONTACT PIN	BE-CU C17300	GOLD PL.50 u"/NICKEL/COPPER
FERRULE	BRASS C3604	GOLD PL.10 u"/NICKEL/COPPER
BARREL	STAINLESS STEEL	PASSIVATION

ELECTRICAL CHARACTERISTICS	
IMPEDANCE	50 Ω
VOLTAGE RATING	335 V(rms)
FREQUENCY RANGE	0 ~ 26.5 GHz
DIELECTRIC WITHSTANDING VOLTAGE	>1000 V
CONTACT RESISTANCE	CENTER CONTACT <3.0 mΩ
	OUTER CONTACT <2.0 mΩ
INSULATION RESISTANCE	>5000 MΩ
INSERTION LOSS	ACCORDING AS THE CABLE
VSWR	<1.30
3RD INTERMODULATION	N/A

MECHANICAL CHARACTERISTICS	
FORCE TO ENGAGE AND DISENGAGE	N/A
CENTER CONTACT RETENTION FORCE	>6 lbs
RECOMMENDED COUPLING TORQUE	9-14 in-lbs
COUPLING NUT RETENTION FORCE	>60 lbs
DURABILITY	>500 cycles

ENVIRONMENTAL PARAMETER	
TEMPERATURE RANGE	-55 °C~+125 °C
RELATIVE HUMIDITY	US MIL- STD 202, Meth. 106
TVIBRATION	US MIL- STD 202, Meth. 204, Cond. D
SHOCK	US MIL- STD 202, Meth. 213, Cond. I
CORROSION	US MIL- STD 202, Meth. 101, Cond. B

* CUSTOMER OUTLINE DRAWING

UNLESS OTHERWISE SPECIFIED:
1) EDGES : C0.15 MAX ;
2) REMOVE ALL BURRS ;
3) SURFACE ROUGHNESS : Ra1.6 ;
4) UNITS : mm ;
5) DIMENSIONS TOLERANCES
DECIMALS : .x ±0.3 .xx ±0.2 .xxx±0.1;
ANGLES : ± 5°.

THIRD ANGLE PROJECTION

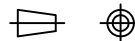

APPROVED :

CUSTOMER P/N :

CHECKED :

SCALE :

2:1

DRAWING :

GUO

DATE : 2020-07-22

PAGE : 1/1



TITLE : 3.5mm MALE S/T SOLDER FOR SFT-205-PUR CABLE,50Ω

DRAWING NO. :

5P3M15S-A408

COMPANY WEBSITE : www.slkcorp.com

CUSTOMER OUTLINE DRAWING