

REV	DESCRIPTION	ECN NO	NAME	DATE
0	FIRST EDITION	N/A	YY	2013-02-19
1	UPDATED DRAWING	N/A	YWD	2018-11-09
2	NEW FRAME	N/A	Liu	2020-07-04

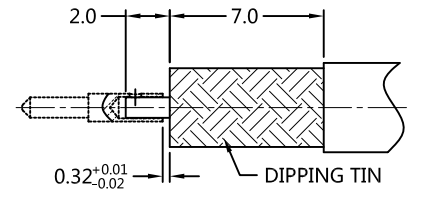

ALL PARTS MUST MEET TO RoHS REQUIREMENTS

REMARKS:
 1.CONTACT PIN TO SOLDER
 2.CRIMPED FERRULE HEX. CRIMP SIZE .198"
 3.ADD SIZE : 6.0 mm



RECOMMENDED CABLE STRIPPING DIM'S

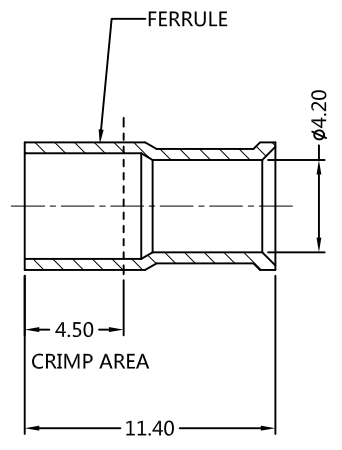
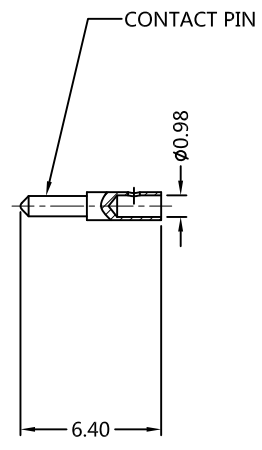
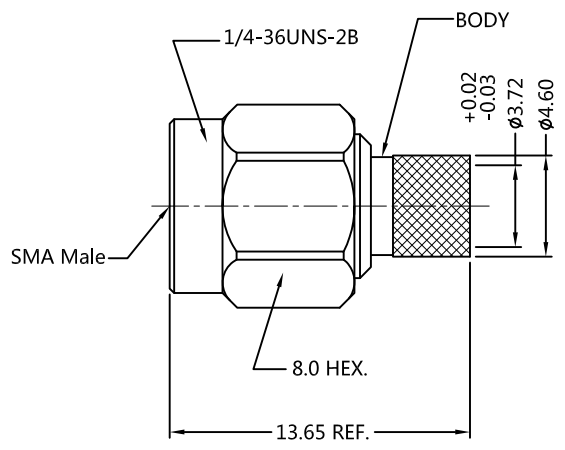

MATERIALS AND PLATING		UNIT: MICRO-INCHES
BODY	STAINLESS STEEL	GOLD 5 u"/NICKE
CONTACT PIN	Be-Cu C17300	GOLD 30 u"/NICKEL/COPPER
INSULATOR	PTFE ASTM-D-1710	N/A
FERRULE	BRASS	GOLD 3 u"/NICKEL/COPPER
SHELL	STAINLESS STEEL	PASSIVATION

ELECTRICAL CHARACTERISTICS		
IMPEDANCE	50 Ω	
VOLTAGE RATING	175 V(rms)	
FREQUENCY RANGE	DC~26.5 GHz	
DIELECTRIC WITHSTANDING VOLTAGE	>500 V	
CONTACT RESISTANCE	CENTER CONTACT	<3.0 mΩ
	OUTER CONTACT	<2.0 mΩ
INSULATION RESISTANCE	>5000 MΩ	
INSERTION LOSS	<0.05√F dB	
VSWR	<1.35	
3RD INTERMODULATION	N/A	

MECHANICAL CHARACTERISTICS	
FORCE TO ENGAGE AND DISENGAGE	N/A
CENTER CONTACT RETENTION FORCE	N/A
RECOMMENDED COUPLING TORQUE	7~10 in-lbs
COUPLING NUT RETENTION FORCE	>60 lbs
DURABILITY	>500 cycles

ENVIRONMENTAL CHARACTERISTICS	
TEMPERATURE RANGE	-40 °C~+125 °C
THERMAL SHOCK	MIL- STD 202, Meth. 107,Cond. B
VIBRATION	MIL- STD 202, Meth. 204,Cond. D
SHOCK	MIL- STD 202, Meth. 213,Cond. I

CUSTOMER OUTLINE DRAWING

* CUSTOMER OUTLINE DRAWING

UNLESS OTHERWISE SPECIFIED:
 1) C0.15 MAX;
 2) REMOVE ALL BURRS;
 3) SURFACE ROUGHNESS : Ra1.6;
 4) UNITS:mm;
 5) DIMENSIONS TOLERANCES
 DECIMALS .x ±0.3 .xx ±0.2 .xxx±0.1
 ANGLES ±5°

THIRD ANGLE PROJECTION		
APPROVED:	CUSTOMER P/N:	-
CHECKED:	SCALE:	1:1
DRAWING:	DATE:	2020-07-04
COMPANY WEBSITE: www.slkcorp.com		

TITLE: SMA MALE S/T CRIMP FOR TFLEX-402 CABLE,50Ω
 DRAWING NO: 5P9M15S-A81