

REV	DESCRIPTION	ECN NO	NAME	DATE
0	FIRST EDITION	N/A	SK	2016-08-17
1	NEW FRAME	N/A	Liu	2020-06-23

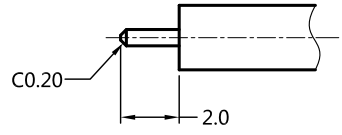

ALL PARTS MUST MEET TO RoHS REQUIREMENTS

REMARKS:
 1.CONTACT PIN TO CAPTIVE
 2.BODY TO SOLDER
 3.ADDS SIZE:7.9mm



RECOMMENDED CABLE STRIPPING DIM'S

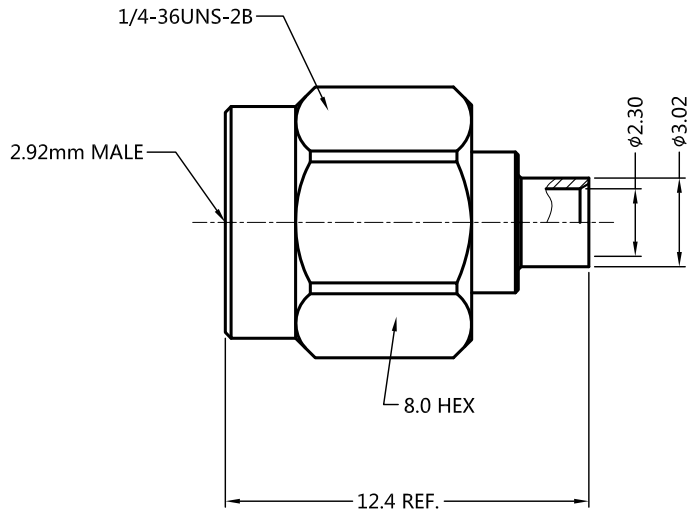

MATERIALS AND PLATING		UNIT: MICRO-INCHES	ELECTRICAL CHARACTERISTICS	
BODY	STAINLESS STEEL	PASSIVATION	IMPEDANCE	50 Ω
		GOLD 30 u"/NICKEL/COPPER	VOLTAGE RATING	175 V(rms)
CONTACT PIN	Be-Cu C17300	GOLD 50 u"/COPPER	FREQUENCY RANGE	DC ~ 40 GHz
INSULATOR	PEEK	N/A	DIELECTRIC WITHSTANDING VOLTAGE	>500 V
SHELL	STAINLESS STEEL	PASSIVATION	CONTACT RESISTANCE	CENTER CONTACT <3.0 m Ω OUTER CONTACT <2.0 m Ω
			INSULATION RESISTANCE	>5000 M Ω
			INSERTION LOSS	<0.05 \sqrt{F} dB
			VSWR	<1.35
			3RD INTERMODULATION	N/A
MECHANICAL CHARACTERISTICS			ENVIRONMENTAL CHARACTERISTICS	
FORCE TO ENGAGE AND DISENGAGE		N/A	TEMPERATURE RANGE	-40 $^{\circ}$ C ~ +125 $^{\circ}$ C
CENTER CONTACT RETENTION FORCE		>6 lbs	THERMAL SHOCK	MIL- STD 202, Meth. 107,Cond. B
RECOMMENDED COUPLING TORQUE		7~10 in-lbs	VIBRATION	MIL- STD 202, Meth. 204,Cond. D
COUPLING NUT RETENTION FORCE		>60 lbs	SHOCK	MIL- STD 202, Meth. 213,Cond. I
DURABILITY		>500 cycles		

CUSTOMER OUTLINE DRAWING

* CUSTOMER OUTLINE DRAWING

UNLESS OTHERWISE SPECIFIED:
 1) C0.15 MAX;
 2) REMOVE ALL BURRS;
 3) SURFACE ROUGHNESS : Ra1.6;
 4) UNITS:mm;
 5) DIMENSIONS TOLERANCES
 DECIMALS .x \pm 0.3 .xx \pm 0.2 .xxx \pm 0.1
 ANGLES \pm 5 $^{\circ}$

THIRD ANGLE PROJECTION		
APPROVED:	CUSTOMER P/N:	
CHECKED:	SCALE:	
DRAWING:	DATE: 2020-06-23	

SLK
 SUPERLINK

TITLE: 2.92mm MALE S/T SOLDER FOR SLD-086 CABLE,50 Ω

DRAWING NO: 5P9M15S-A471-002

COMPANY WEBSITE: www.slkcorp.com