

REV.	DESCRIPTION	ECN NO.	NAME	DATE
1	NEW FRAME	N/A	HYH	2020-08-24

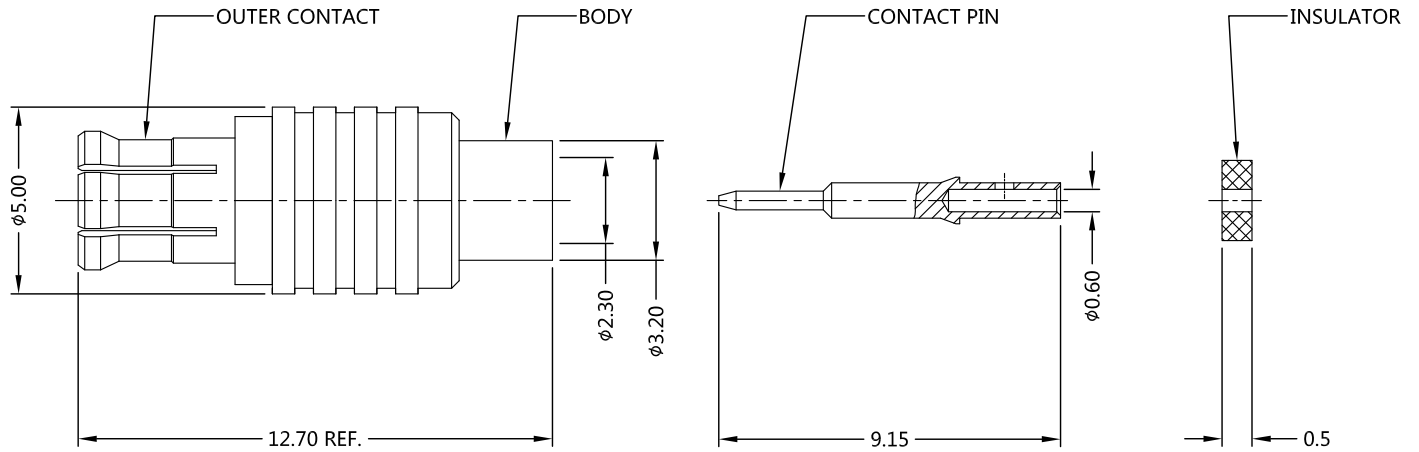

ALL PARTS MUST MEET TO RoHS REQUIREMENTS

REMARKS:
1. ADD SIZES :6.9mm
2. CONTACT PIN TO SOLDER

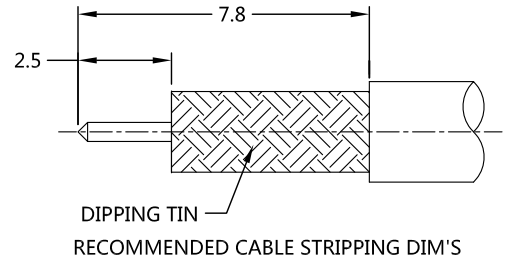

MATERIALS AND PLATING		UNIT: MICRO-INCHES
PART NAME	MATERIALS	PLATING
OUTER CONTACT	BERYLLIUM COPPER	GOLD PL.3u"/NICKEL/COPPER
CONTACT PIN	BRASS C3604	GOLD PL.5u"/NICKEL/COPPER
INSULATOR	PTFE ASTM-D-1710	N/A
BODY	BRASS C3604	GOLD PL.3u"/NICKEL/COPPER

ELECTRICAL CHARACTERISTICS		
IMPEDANCE	50 Ω	
VOLTAGE RATING	335 V(rms)	
FREQUENCY RANGE	0 ~ 6 GHz	
DIELECTRIC WITHSTANDING VOLTAGE	500 V	
CONTACT RESISTANCE	CENTER CONTACT	<5.0 m Ω
	OUTER CONTACT	<2.5 m Ω
INSULATION RESISTANCE	>1000 M Ω	
INSERTION LOSS	<0.10 $\times \sqrt{F(\text{GHz})}$ dB	
RETURN LOSS	N/A	
VSWR	<1.3	
3RD INTERMODULATION	N/A	

MECHANICAL CHARACTERISTICS	
FORCE TO ENGAGE	< 14 lbs
FORCE TO DISENGAGE	1.5 ~ 4.5 lbs
CENTER CONTACT RETENTION FORCE	N/A
DURABILITY	>500 cycles

ENVIRONMENTAL PARAMETER	
TEMPERATURE RANGE	-55 $^{\circ}\text{C}$ ~ +125 $^{\circ}\text{C}$

* CUSTOMER OUTLINE DRAWING

UNLESS OTHERWISE SPECIFIED:
1) EDGES : C0.15 MAX ;
2) REMOVE ALL BURRS ;
3) SURFACE ROUGHNESS : Ra1.6 ;
4) UNITS : mm ;
5) DIMENSIONS TOLERANCES
DECIMALS : .x ± 0.3 .xx ± 0.2 .xxx ± 0.1 ;
ANGLES : $\pm 5^{\circ}$.

THIRD ANGLE PROJECTION

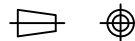

APPROVED :	CUSTOMER P/N :
CHECKED :	SCALE :
DRAWING :	DATE :
HYH	2020-08-24
	PAGE : 1/1



TITLE : MCX MALE S/T SOLDER
FOR TFLEX-405(.086") CABLE,50 Ω
DRAWING NO. :
5MXM15S-S01-007
COMPANY WEBSITE : www.slkcorp.com

CUSTOMER OUTLINE DRAWING