

REV.	DESCRIPTION	ECN NO.	NAME	DATE
2	ADD NUT AND WASHER	N/A	ZLX	2018-05-14
3	MODIFY THE WASHER MATERIAL	N/A	Ming	2020-06-06
4	MODIFY THE WASHER MATERIAL	N/A	Ming	2020-06-08
5	UPDATE THE DRAWING FRAME	N/A	PY	2020-06-20

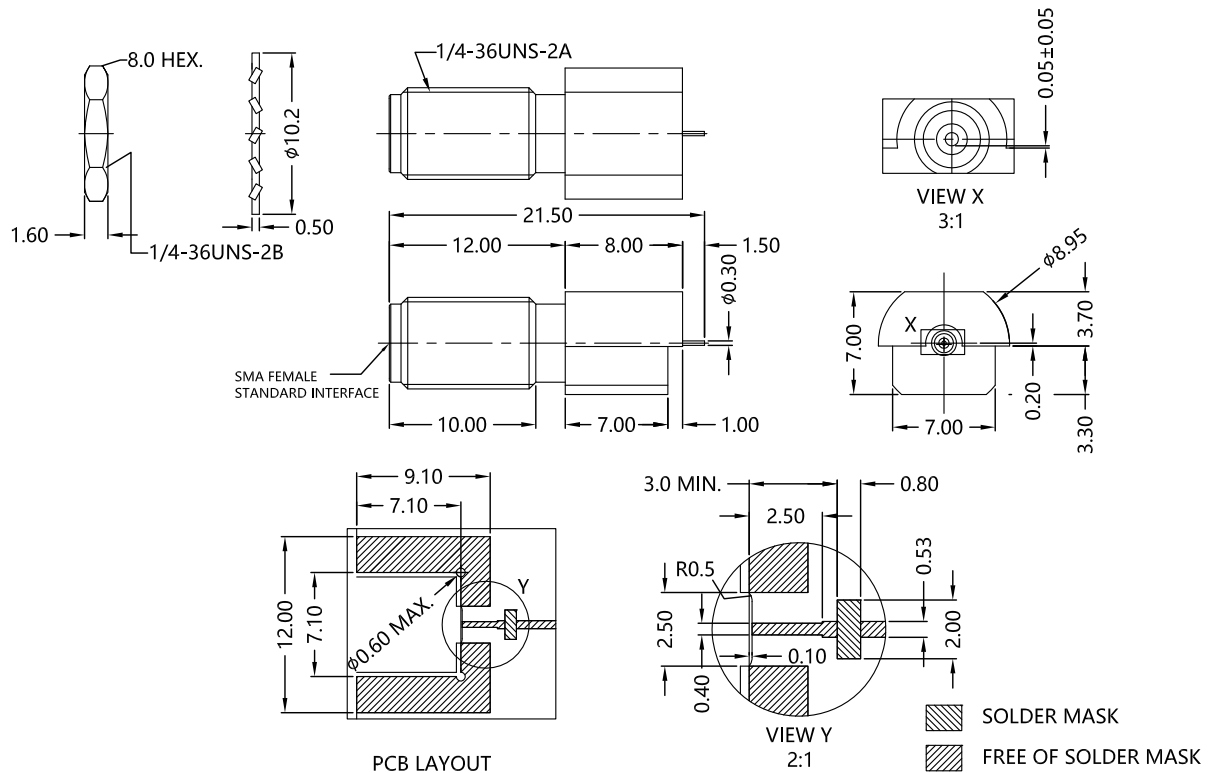

ALL PARTS MUST MEET TO RoHS REQUIREMENTS



MATERIALS AND PLATING		UNIT: MICRO-INCHES
PART NAME	MATERIALS	PLATING
BODY	BRASS C3604	GOLD 3 u"/ NICKEL/ COPPER
INSULATOR	PTFE ASTM-D-1710	N/A
CONTACT PIN	BE-CU	GOLD 5 u"/ NICKEL/ COPPER
WASHER	BRASS C3604	GOLD 3 u"/ NICKEL/ COPPER
NUT	BRASS C3604	GOLD 3 u"/ NICKEL/ COPPER

ELECTRICAL CHARACTERISTICS	
IMPEDANCE	50 Ω
VOLTAGE RATING	170 V(rms)
FREQUENCY RANGE	0 ~ 18 GHz
DIELECTRIC WITHSTANDING VOLTAGE	>500 V
CONTACT RESISTANCE	CENTER CONTACT
	OUTER CONTACT
INSULATION RESISTANCE	>5000 MΩ
INSERTION LOSS	<0.20 dB
VSWR	<1.30
3RD INTERMODULATION	N/A

MECHANICAL CHARACTERISTICS	
FORCE TO ENGAGE AND DISENGAGE	N/A
CENTER CONTACT RETENTION FORCE	> 6 lbs
RECOMMENDED COUPLING TORQUE	N/A
COUPLING NUT RETENTION FORCE	N/A
DURABILITY	> 500cycles

ENVIRONMENTAL PARAMETER	
TEMPERATURE RANGE	-65 °C~+165 °C
THERMAL SHOCK	MIL- STD 202, Meth. 107,Cond. B
VIBRATION	MIL- STD 202, Meth. 204,Cond. D
SHOCK	MIL- STD 202, Meth. 213,Cond. I

* CUSTOMER OUTLINE DRAWING

UNLESS OTHERWISE SPECIFIED:
 1) EDGES : C0.15 MAX ;
 2) REMOVE ALL BURRS ;
 3) SURFACE ROUGHNESS : Ra1.6 ;
 4) UNITS : mm ;
 5) DIMENSIONS TOLERANCES
 DECIMALS : .x ±0.3 .xx ±0.2 .xxx±0.1;
 ANGLES : ± 5°.

THIRD ANGLE PROJECTION



APPROVED :

CUSTOMER P/N :

CHECKED :

SCALE :

1: 1

DRAWING :

DATE : 2020-06-20

PAGE : 1/1



TITLE : SMA FEMALE S/T FOR PCB EDGE LAUNCH,50Ω

DRAWING NO. : 5MAF28S-P21-005

COMPANY WEBSITE : www.slkcorp.com

CUSTOMER OUTLINE DRAWING