

REV.	DESCRIPTION	ECN NO.	NAME	DATE
1	NEW FRAME	N/A	LDH	2020-9-8

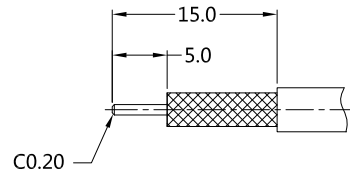

ALL PARTS MUST MEET TO RoHS REQUIREMENTS

REMARK:
1. ADDS SIZE:21.05mm
2. CONTACT PIN TO SOLDER



RECOMMENDED CABLE STRIPPING DIM'S

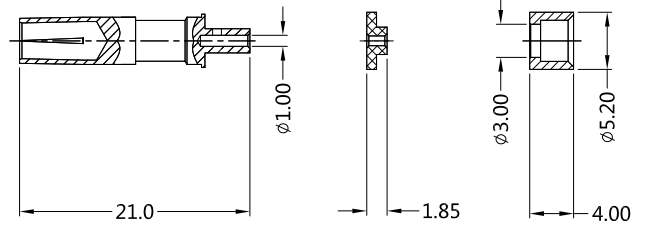
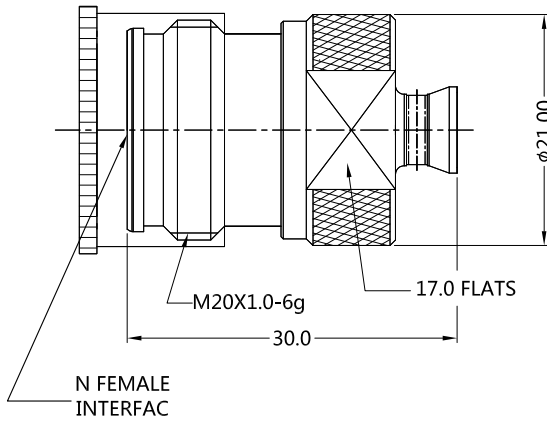

MATERIALS AND PLATING		UNIT: MICRO-INCHES
PART NAME	MATERIALS	PLATING
BODY/FERRULE	NON-MAGNETIC BRASS	ALBALOY 120u"/COPPER
CONTACT PIN	NON-MAGNETIC PHOSPHOR BRONZE	SILVER 200 u"/COPPER
INSULATOR	PTFE ASTM-D-1710	N/A
OUT CONDUCT	NON-MAGNETIC PHOSPHOR BRONZE	ALBALOY 120 u"/COPPER
BARREL	NON-MAGNETIC BRASS	SILVER 200 u"/COPPER

ELECTRICAL CHARACTERISTICS	
IMPEDANCE	50 Ω
VOLTAGE RATING	500 V(rms)
FREQUENCY RANGE	0 ~ 6 GHz
DIELECTRIC WITHSTANDING VOLTAGE	1000 V
CONTACT RESISTANCE	CENTER CONTACT <1.0 mΩ
	OUTER CONTACT <0.25 mΩ
INSULATION RESISTANCE	>5000 MΩ
INSERTION LOSS	ACCORDING TO THE CABLE
VSWR	<1.15 @ 0-3GHz <1.30 @ 3-6GHz
3RD INTERMODULATION	<-160dBc@900MHz/1800MHz 2x43dBm

MECHANICAL CHARACTERISTICS	
FORCE TO ENGAGE AND DISENGAGE	N/A
CENTER CONTACT RETENTION FORCE	>32N
COUPLING PROOF TORQUE	N/A
COUPLING NUT RETENTION FORCE	N/A
DURABILITY	>500 cycles

ENVIRONMENTAL PARAMETER	
TEMPERATURE RANGE	-55 °C~+125 °C

* CUSTOMER OUTLINE DRAWING

UNLESS OTHERWISE SPECIFIED:
1) EDGES : C0.15 MAX ;
2) REMOVE ALL BURRS ;
3) SURFACE ROUGHNESS : Ra1.6 ;
4) UNITS : mm ;
5) DIMENSIONS TOLERANCES
DECIMALS : .x ±0.3 .xx ±0.2 .xxx±0.1;
ANGLES : ± 5°.

THIRD ANGLE PROJECTION

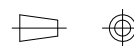

APPROVED :

CUSTOMER P/N :

CHECKED :

SCALE :

3 : 2

DRAWING :

LDH

DATE : 2020-9-8

PAGE : 1/1



TITLE : 4.3-10 FEMALE S/T FOR TFT-402-LF CABLE,50Ω

DRAWING NO. : NM-5SDF15S-S02-005

COMPANY WEBSITE : www.slkcorp.com

CUSTOMER OUTLINE DRAWING