

REV.	DESCRIPTION	ECN NO.	NAME	DATE
A	FIRST EDITION	N/A	Dong	2012-11-09
A1	REPLACE FRAME	N/A	Kevin.Li	2020-06-21

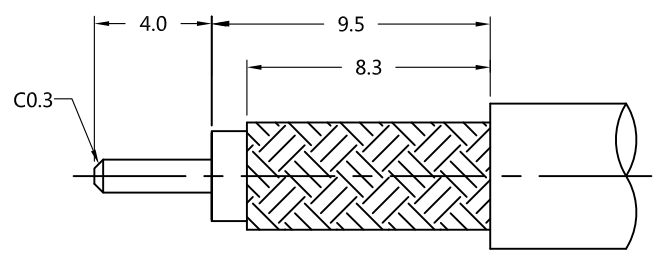

ALL PARTS MUST MEET TO RoHS REQUIREMENTS

REMARKS:  
 1. CRIMPED FERRULE HEX. CRMIP SIZE .256"  
 2. CONTACT PIN TO CAPTIVE



RECOMMENDED MOUNTING HOLE DIM'S

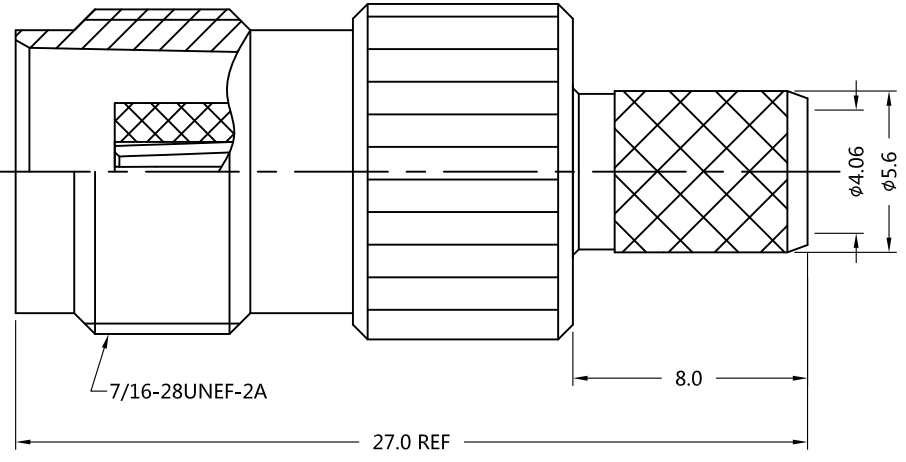
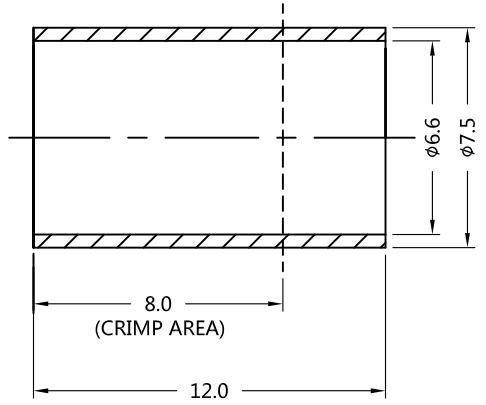

MATERIALS AND PLATING		UNIT: MICRO-INCHES
PART NAME	MATERIALS	PLATING
BODY	BRASS	NICKEL 100u" / COPPER
INSULATOR	PTFE ASTM-D-1710	N/A
CONTACT PIN	PHOPSHOR BRONZE	GOLD 30u" / NICKEL
FERRULE	COPPER	NICKEL 100u" / COPPER
OTHER	BRASS	NICKEL 100u" / COPPER

ELECTRICAL CHARACTERISTICS	
IMPEDANCE	50 Ω
VOLTAGE RATING	500V(rms)
FREQUENCY RANGE	0 ~ 6GHz
DIELECTRIC WITHSTANDING VOLTAGE	>1000 V
CONTACT RESISTANCE	CENTER CONTACT <3.0 mΩ
	OUTER CONTACT <2.0 mΩ
INSULATION RESISTANCE	>5000MΩ
INSERTION LOSS	ACCORDING AS THE CABLE
VSWR	<1.3
3RD INTERMODULATION	N/A

MECHANICAL CHARACTERISTICS	
FORCE TO ENGAGE AND DISENGAGE	N/A
CENTER CONTACT RETENTION FORCE	> 6 lbs
RECOMMENDED COUPLING TORQUE	N/A
COUPLING NUT RETENTION FORCE	N/A
DURABILITY	> 500cycles

ENVIRONMENTAL PARAMETER	
TEMPERATURE RANGE	-55°C- +155°C
VIBRATION	US MIL- STD 202, Meth. 204, Cond. B
SHOCK	US MIL- STD 202, Meth. 213, Cond. I
THERMAL SHOCK	US MIL- STD 202, Meth. 107, Cond. B
CLIMATIC CLASS	IEC 60068 65/165/21

\* CUSTOMER OUTLINE DRAWING

UNLESS OTHERWISE SPECIFIED:  
 1) EDGES : C0.15 MAX ;  
 2) REMOVE ALL BURRS ;  
 3) SURFACE ROUGHNESS : Ra1.6 ;  
 4) UNITS : mm ;  
 5) DIMENSIONS TOLERANCES  
 DECIMALS : .x ±0.3 .xx ±0.2 .xxx±0.1;  
 ANGLES : ± 5°.

THIRD ANGLE PROJECTION	
APPROVED :	CUSTOMER P/N :
CHECKED :	SCALE :
DRAWING :	DATE : 2020-06-21
PAGE : 1/1	

TITLE : TNC FEMALE S/T CRIMP FOR LMR240 CABLE , 50Ω  
 DRAWING NO. : 5TCF11S-A46-002  
 COMPANY WEBSITE : www.slkcorp.com

CUSTOMER OUTLINE DRAWING