

REV.	DESCRIPTION	ECN NO.	NAME	DATE
A0	FIRST EDITION	N/A	WYJ	2017-06-02
A1	UPDATE DRAWING	N/A	JASON	2020-05-24

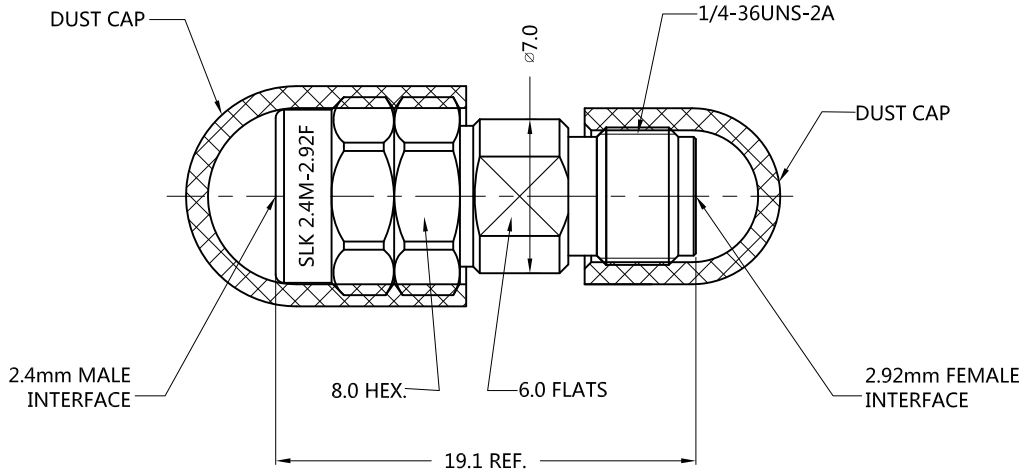

ALL PARTS MUST MEET TO RoHS REQUIREMENTS



MATERIALS AND PLATING		UNIT: MICRO-INCHES
PART NAME	MATERIALS	PLATING
BODY/SHELL	STAINLESS STEEL	PASSIVATION
CONTACT PIN	Be-Cu C17300	GOLD PL./COPPER
INSULATOR	ENGINEERING PLASTIC	N/A
DUST CAP	PVC	N/A

ELECTRICAL CHARACTERISTICS		
IMPEDANCE	50 Ω	
VOLTAGE RATING	335 V(rms)	
FREQUENCY RANGE	0 ~ 40 GHz	
DIELECTRIC WITHSTANDING VOLTAGE	> 500 V	
CONTACT RESISTANCE	CENTER CONTACT	< 3.0 mΩ
	OUTER CONTACT	< 2.0 mΩ
INSULATION RESISTANCE	> 500 MΩ (2.4mm) > 1000 MΩ (2.92mm)	
INSERTION LOSS	< 0.05x√F(GHz) dB	
VSWR	< 1.20	
3RD INTERMODULATION	N/A	

MECHANICAL CHARACTERISTICS	
FORCE TO ENGAGE AND DISENGAGE	< 4.5 N (2.92mm)
CENTER CONTACT RETENTION FORCE	> 6 lbs
RECOMMENDED COUPLING TORQUE	7-10 in.lbs (2.4mm)
COUPLING NUT RETENTION FORCE	> 60 lbs (2.4mm)
DURABILITY	> 500 cycles

ENVIRONMENTAL PARAMETER	
TEMPERATURE RANGE	-40 °C ~ +85 °C

*** CUSTOMER OUTLINE DRAWING**

UNLESS OTHERWISE SPECIFIED:
 1) EDGES : C0.15 MAX ;
 2) REMOVE ALL BURRS ;
 3) SURFACE ROUGHNESS : Ra1.6 ;
 4) UNITS : mm ;
 5) DIMENSIONS TOLERANCES
 DECIMALS : .x ±0.3 .xx ±0.2 .xxx±0.1 ;
 ANGLES : ± 5°.

THIRD ANGLE PROJECTION

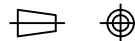

APPROVED :
 CHECKED :
 DRAWING : JASON

CUSTOMER P/N :
 SCALE : 1 : 1
 DATE : 2020-05-24
 PAGE : 1/1



TITLE : 2.4mm MALE TO 2.92mm FEMALE ADAPTER
 DRAWING NO. : T-5P4M06S-P9F-005
 COMPANY WEBSITE : www.slkcorp.com

CUSTOMER OUTLINE DRAWING